

## System FC194

**Penetration Detail:** Electric Cables & Conduits with or without Cable Tray fire-stopped with Protecta EX Mortar

**Separating Element:** Min. 150mm thick Concrete, Masonry or ACC Wall (min. 650kg/m<sup>3</sup>)

**Cable Types:** Insulated copper or aluminium cables, fibre optic cables, and bundled communication cables, excluding hollow cables.

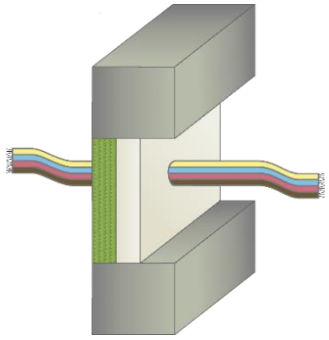

Protecta®

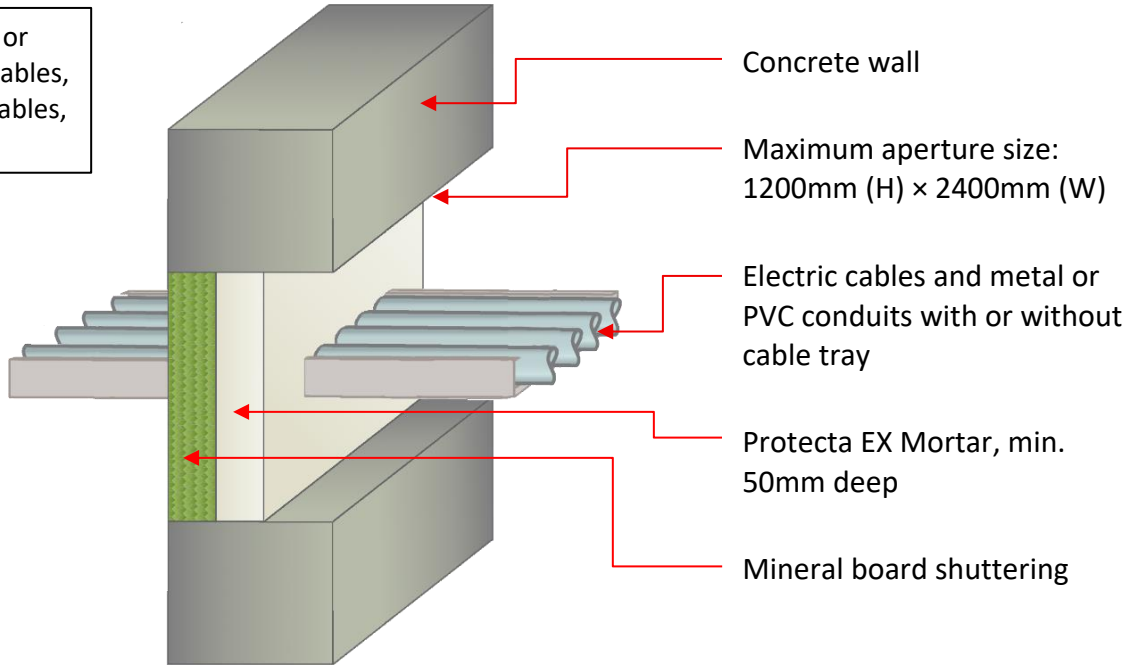

**Installation Instructions:**

1. Clean apertures of dust, grease, and debris.
2. Seal may be positioned on either side of the construction or within the depth.
3. Penetrations a min. 25mm separation from seal edges and min. 30mm from other penetrations.
4. Friction fit min. 50mm thick mineral wool shutter board shuttering (min. 150kg/m<sup>3</sup> density) within aperture. Seal gaps with Protecta FR Acrylic.
5. Add mortar to clean water and mix to required lump-free consistency (do not add water to mortar).
6. Apply/trowel into aperture, ensuring full coverage around services and corners. Compact to remove air voids and build to required min. 50mm depth.

**Services & Ratings (FRR)**

Service Penetration	Cable Sizes	FRR
None (blank)	N/A	-/180/120
Single cable	≤21mm	-/180/60
*Single cable		-/240/60
Electric cables	≤21mm (single, bundles or on tray)	-/180/60
	≤50mm (single, bundles or on tray)	-/180/45
	≤80mm (single, bundles or on tray)	-/120/45
Telecommunication cables	≤21mm (single, bundles) ≤100mm	-/180/90

Service Penetration	Cable & Conduit Sizes	FRR
Copper conduit	≤16mm	-/180/30
Steel conduit		-/180/60
PVC conduit		
Steel cable trays & ladders	N/A	
Non-sheathed wires	≤17mm	-/180/45
	≤24mm	-/180/30
*Aperture size: 80mm x 80mm		

**Compliance**

**Report** Jensen Hughes 53619700C  
**Rev/Ref** R4.4 / FAS210027, 260234  
**Page** 18  
**Standards** AS1530.4-2014 & AS4072.1-2005

Firestop Centre Technical Support:  
 Tel: +64 9 483 4000  
[info@firestopcentre.co.nz](mailto:info@firestopcentre.co.nz)  
[www.firestopcentre.co.nz](http://www.firestopcentre.co.nz)

Drawing Rev: 1.1

Scale: NTS

**Disclaimer:** Firestop Centre may change product specifications without notice as part of our ongoing development and testing. All information in this document is provided in good faith and for guidance only. All drawings are for illustration purposes only and may not reflect the actual product. Since we cannot control how the product is installed or the conditions on-site, we do not guarantee the product's performance. We also accept no responsibility for any loss, damage, or injury resulting from the use of this information.